

58 Lacey Street Kogarah Bay NSW

- It's close to Beverley Park Golf Club, shops and bus stops.
- Character filled family home spans two impressive levels
- Well maintained interiors with multiple living/dining zones
- Outdoor area reveals beautifully manicured gardens and lawn
- Two original kitchens appointed with gas cooktops, storage
- Two neat main bathrooms complete with separate bath/shower
- Flexible double level layout offering five generous bedrooms
- Driveway leads to triple lock-up garage with extra storage
- Short walk to Blakehurst Public School and nature reserves

5 🏠 3 🚗 2 🚗

View : <https://www.luxebyymm.com.au/lease/nsw/st-george/kogarah-bay/residential/house/7766690>



Sookie Yue Luo
02 9547 0008

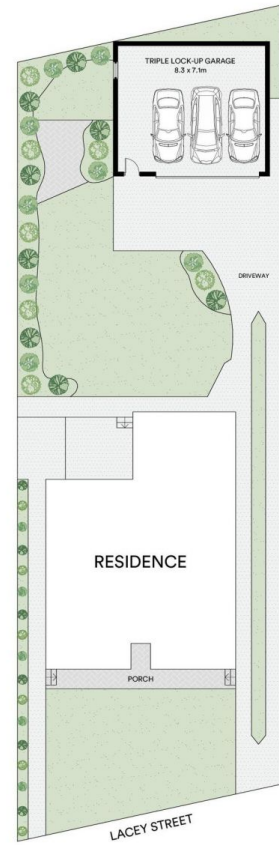

All information contained in this document is from sources we believe to be accurate, however we cannot guarantee its accuracy. Interested persons should make and rely on their own enquiries in relation to measurements, dimensions, layout, furniture and descriptions.